

Curve Alignment  
 Curve 51-38.5  
 Length 1307.7  
 S.C. 5000 + 58.8

100 ft wide, 50 ft each side center line, through  $\frac{1}{4}$  NE  $\frac{1}{4}$  & SE  $\frac{1}{4}$  NW  $\frac{1}{4}$  Sec 21  
 Appropriated by the L&L Ry Co from Geo. Breece for \$1200 (with other land  
 money paid into Court as per c/f Probate Judge Melly 10-1-72 B91)  
 Rec'd

100 ft wide, 50 ft each side center line through NE  $\frac{1}{4}$  NE  $\frac{1}{4}$   
 Appropriated by L&L Ry Co from J.R. Hall (SEC 21  
 Judgment for \$700 money paid into court as per c/f  
 Probate Judge Melly 5-28-73 B92

100 ft wide, 50 ft each side  
 through SE  $\frac{1}{4}$  SE  $\frac{1}{4}$  of Sec 16  
 Appropriated from Geo Breece  
 Judgment \$1200 (with other lands) money  
 paid into Court as per c/f Probate Judge  
 Melly 10-1-72 B91

100 ft wide through the South part of the SW  $\frac{1}{4}$  SW  $\frac{1}{4}$  SEC 15  
 Appropriated from lease Hall by L&L Ry Co. Judgment for \$100 money paid  
 into Court as per c/f Probate Judge Melly, 10-1-72, B90

100 ft wide, 50 ft each side center line  
 across West side E  $\frac{1}{2}$  SW  $\frac{1}{4}$  SEC 15  
 Elias Bowsher & Wife to L&L Ry Co  
 deed 12-9-72 B93  
 Rec'd Dec. 27/72 Vol 20 P. 113

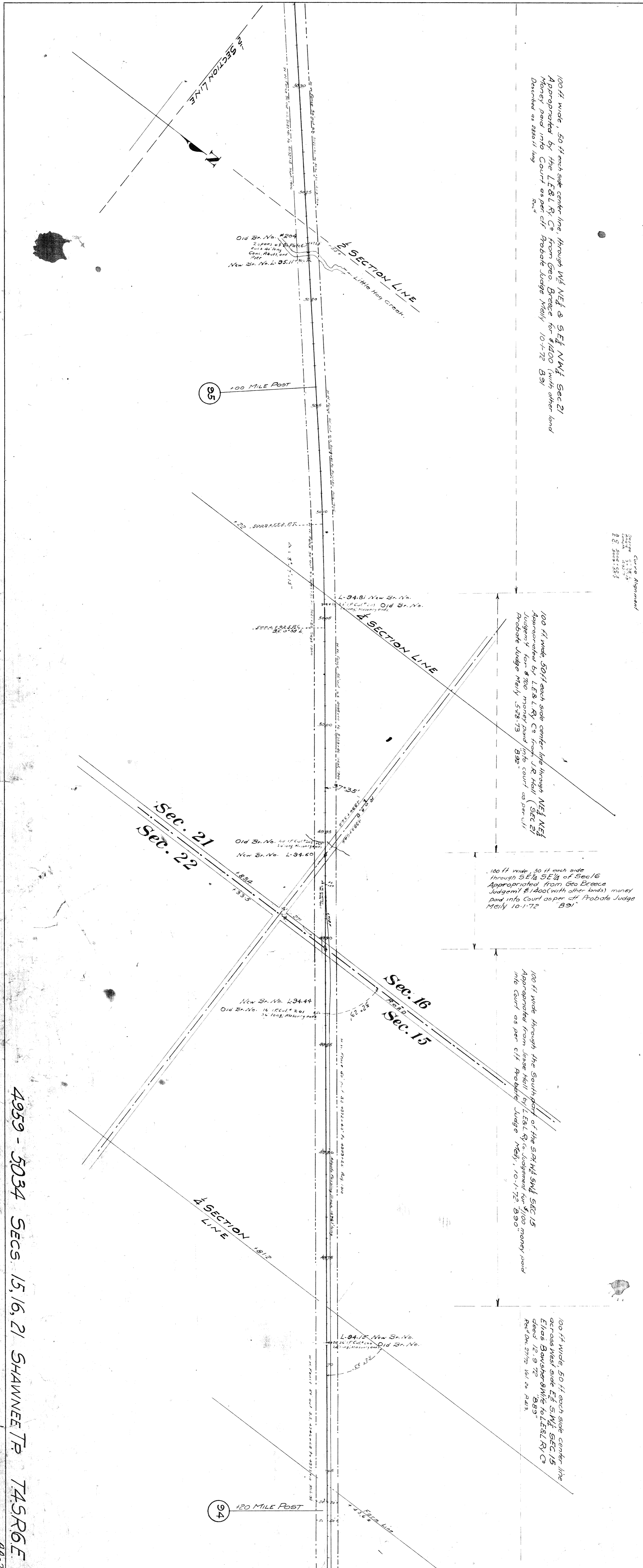

4959 - 5034 SECS. 15, 16, 21 SHAWNEE TWP T45R6E

14 ALLEN CO OHIO AA-79