

CITY OF LIMA

ALLEN CO. - OHIO
BATH TWP.
T-35-R-7E



0° 40'
111° 45'



FOR SCHEDULE OF CHANGES AFTER
DATE OF VALUATION SEE SHEETS NOS. 36A, 36B

Note: Only those tracks and other facilities which
are so designated or which are on lines, easements,
T & C property, belonging to the B & O R.R.

Scale: 1/8" = 100' (Horizontal)
1/4" = 100' (Vertical)

STATION MAP
THE BALTIMORE AND OHIO RAILROAD COMPANY
DAYTON AND MICHIGAN RAILROAD COMPANY
OPERATED BY
THE BALTIMORE AND OHIO RAILROAD COMPANY
TOLEDO-INDIANAPOLIS DIV.
MAIN LINE

STATION 091650 TO STATION 6503100
JUNE 30, 1918
OFFICE OF VALUATION ENGINEER
BALTIMORE, MD.

Match Mark for Sheet No. 537

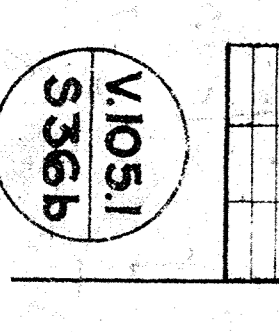

REVISION NO.	DATE	DESCRIPTION
1	1918	Original
2	1918	As shown
3	1918	As shown
4	1918	As shown
5	1918	As shown
6	1918	As shown
7	1918	As shown
8	1918	As shown
9	1918	As shown
10	1918	As shown