

## **ALL-C.R. 142-3.63/4.77; PID 118884 Breese/Shawnee & Breese/Dixie Intersection Improvements**

The Allen County Engineer's Office (ACEO), in partnership with the Ohio Department of Transportation (ODOT), is proposing to upgrade the Breese/Shawnee and Breese/Dixie intersections. These improvements include new mast arm traffic signals, countdown pedestrian signal heads with push buttons, sidewalk landings & ADA curb ramps, radius improvements and drainage improvements where needed. Also included is the addition of a westbound right turn lane at Breese Road onto northbound Shawnee Road. The project is necessary to improve the safety and efficiency of the intersections. Construction is scheduled to begin in June 2028.

Property Impacts: New permanent and temporary right-of-way will need to be acquired for the project. Starting later in 2026, real estate representatives for the Allen County Engineer's Office will be in contact with affected property owners to discuss the right-of-way needs, the acquisition process, and their rights under that process.

Traffic Impacts: Construction of the project will be in phases and access to all adjacent properties will be maintained for the duration of the project. Most of the construction will not require closing the roads to traffic. However, potential reconstruction of the southbound lanes of Dixie Highway may require closing 250' of Dixie Highway north of Breese Road for a maximum of fourteen (14) days. In addition, grinding and paving operations may require closing 210' of Shawnee Road north of Breese Road for approximately three (3) days.

The detour for Dixie Highway would begin at the intersection of Buckeye Road with traffic directed east on Buckeye Road and then south on McClain Road. Vehicles needing to access I-75 would turn east onto Hanthorn Road, then south onto St. Johns Road (SR 65) until the intersection with I-75. Vehicles traveling to Breese Road would continue south on McClain Road to the intersection with Breese Road, then west to Dixie Highway. *See the attached detour map.*

The Shawnee Road detour would begin at the Ft. Amanda Road intersection with traffic directed east on Ft. Amanda Road, then continuing east on Buckeye Road, south on Dixie Highway and then west on Breese Road to Shawnee Road. *See the attached detour map.*

Requesting Public Feedback: To ensure the decision-making process is comprehensive, the Allen County Engineer's Office is seeking comments from the public about the social, environmental, and economic impacts of this proposed project. Environmental impacts include those associated with historic, archaeological, architectural, ecological resources, hazardous materials, maintenance of traffic, access to properties, and general concerns you may have with the project. The Allen County Engineer is requesting public comments by **May 7, 2026**, via the contact information below:

**Allen County Engineer's Office**  
**Attention: Mark Droll, P.E., Operations Engineer**  
**1501 N Sugar St; Lima, OH 45801**  
**Phone: (419) 996-7120**  
**Email: [mdroll@allencountyohio.com](mailto:mdroll@allencountyohio.com)**

We sincerely appreciate your cooperation and assistance so that this worthwhile project can be completed as soon as possible. Public feedback is welcome at any time, but must be received by May 7, 2026 to be formally documented and considered during this project development phase.

**ALL-C.R. 142-3.63/4.77; PID 118884  
BREES/SHAWNEE & BREES/DIXIE INTERSECTION IMPROVEMENTS  
DETOUR MAP**

**DIXIE HIGHWAY NORTH OF BREESE ROAD  
DETOUR ROUTE**

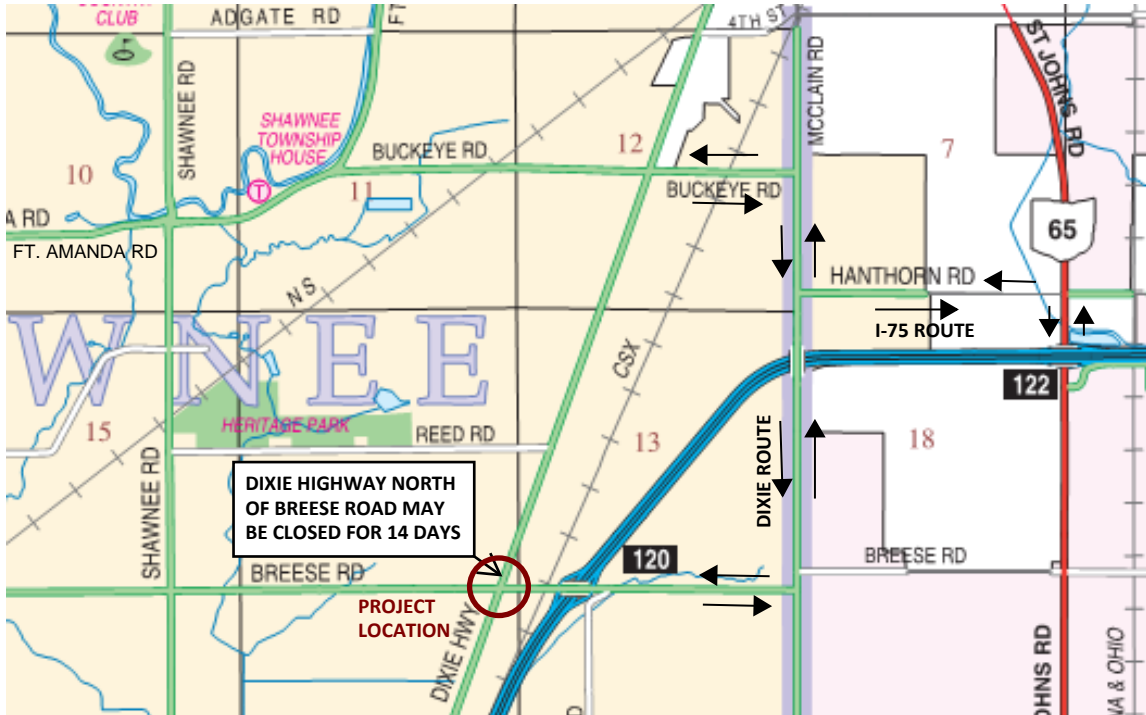

**SHAWNEE ROAD CLOSURE NORTH OF BREESE ROAD  
DETOUR ROUTE**

SHAWNEE ROAD NORTH OF BREESE ROAD MAY BE CLOSED FOR 3 DAYS

